

# PRODUCT SPECIFICATION

**ITEM CODE:** VH-RO4P  
**DESCRIPTION:** COMPACT RO SYSTEM  
**BRAND:** AQUAPRO



## PRODUCT SPECIFICATION:

STAGES:	DESCRIPTION:
<b>1<sup>st</sup></b> Stage	<b>PP:</b> Removes particles before purification process.
<b>2<sup>nd</sup></b> Stage	<b>Pre-Carbon:</b> Removes chlorine, taste, odor, color.
<b>3<sup>rd</sup></b> Stage	<b>Membrane (RO):</b> Greatly Reduces salt in the water.
<b>4<sup>th</sup></b> Stage	<b>Post-Carbon:</b> Removes chlorine, taste, odor, color.

## MAIN PARTS:

- FWC1: FEED WATER CONNECTOR
- IN-LINE FILTER
  - AIP-2: 2" DIA SEDIMENT FILTER
  - AIC-2: 2" DIA GAC FILTER (NSF)
  - AIC-25: 2.5" DIA GAC FILTER (NSF)
- PM6689-50GPD: 50GPD PUMP
- TR-24: 24V CE TRANSFORMER
- EFFICIENCY RO MEMBRANE
- SWDWS: FLOW RESTRICTOR
- A4-P: 5 GAL NSF RO TANK
- ABVL-JC: TANK BALL VALVE
- DNCR-14: DRAIN CONNECTOR 1/4"
- FCCRM: DELUXE FAUCET, CHROME

# PRODUCT OPERATION

## First time operation:

1. Plug in the power supply. Allow several minutes for the system to flush and fill.
2. Do not drink the first tank of water. About one to two hours after the system started, turn on the faucet and drain completely the first tank of water.

## When abnormal conditions occur:

1. Shut off the system. Unplug power supply first, then turn off feed water adapter valve
2. Call authorized service center or distributor. Before calling, please try your best to determine exactly the problem you have encountered by referring to the “Troubleshooting” section.

## Away from home:

1. If you know you are not using the system for more than two weeks, shut off the system and drain the stored water.
2. Turn off feed water adapter valve.

## Restarting the system:

1. Turn on the feed water adapter valve.
2. Plug in the power supply.

# PRODUCT INSTALLATION

Installation method is used depending on the type of water supply piping arrangement in your home.

1. Turn off cold water valve or the main valve.
2. Connect the feed pipe to the inlet connector.
3. let the water run through the system and flush for about 15-20 minutes.
4. connect the outlet pipe to the drainage system.

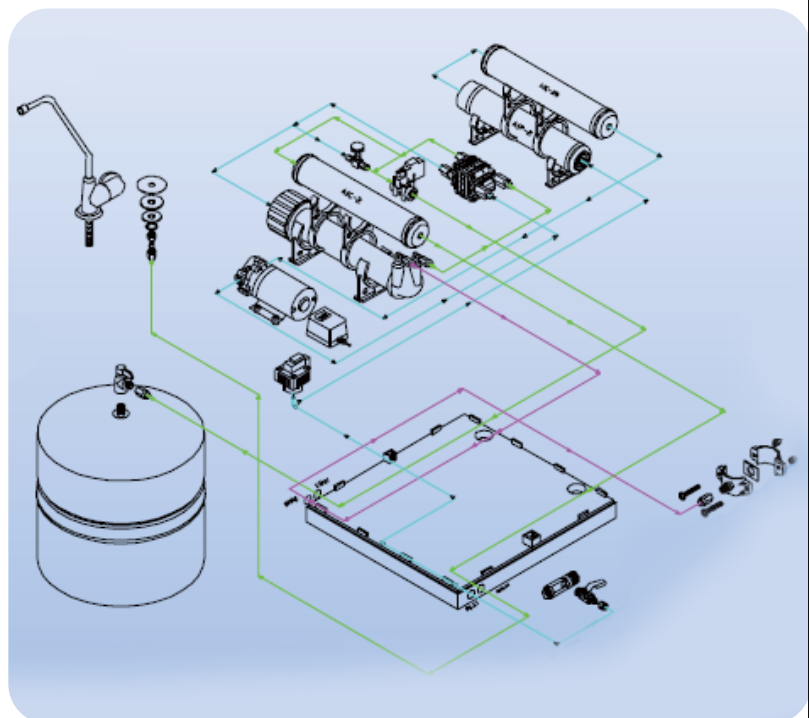

# PRODUCT MAINTENANCE

The replacement of filter cartridges depends greatly on the quality and condition of the water in your area. Use common sense and good judgment to determine the replacement time. To ensure that your reverse osmosis drinking water appliance performs at its maximum capacity please follow the installation instructions and maintenance.

## Cartridges

## Recommended replacement frequency



Replace every 6 months or as often as needed.



- Replace every 2 years or as often as needed.
- Replace when persistent high TDS value exist. Membrane fouled, hydrolyzed, ruptured or attached by bacteria.